

PERMIT

CITY OF NAPOLEON - BUILDING DEPARTMENT

255 West Riverview Avenue, Napoleon, Ohio 43545 - 419-592-4010

Permit No. 870-77 Issued 12-14-77
date

Job Location 90 Duquesne Dr.
address

Lot 60 Riviera Heights 1st Add.
sub div or legal discript

Issued By *D. E. Johnson*
building official

Owner Terry Funchion & Charles Nizzi
name tel.

Address 632 Grover, Defiance

Agent Residential Technology 782-0994
builder-eng.-etc. tel.

Address 632 Grover, Defiance

Description of Use New single family dwelling

Residential XX 1
no. dwelling units

Commercial _____ Industrial _____

New XX Add'n. _____ Alter _____ Remodel _____

Mixed Occupancy _____

Change of Occupancy _____

Estimated Cost \$ 52,000.00

FEES	BASE	PLUS	TOTAL
<input checked="" type="checkbox"/> BUILDING	\$ 87.50	---	\$ 87.50
<input checked="" type="checkbox"/> ELECTRICAL	1.00	18.75	19.75
<input checked="" type="checkbox"/> PLUMBING	3.00	10.00	13.00
<input checked="" type="checkbox"/> MECHANICAL	10.00	---	10.00
<input type="checkbox"/> DEMOLITION			
<input checked="" type="checkbox"/> ZONING	---	---	---
<input type="checkbox"/> SIGN			
WATER TAP	225.00	---	225.00
SEWER TAP	60.00	---	60.00
TEMP. ELECT.	10.00	---	10.00
ADDITIONAL PLAN REVIEW	Struct. _____ hrs		
	Elect. _____ hrs		
TOTAL FEES.....			425.25
LESS MIN. FEES PAID _____			-0-
		<small>date</small>	
BALANCE DUE.....			\$425.25

ZONING INFORMATION

district "A"	lot dimensions 83' x 120'	area 9960 sq'	front yd 30' OK	side yds rt16' lt16' OK	rear yd 56' OK
max hgt Max 25' OK	no pkg spaces 2 req'd	no ldg spaces n/a	max cover 35% OK	petition or appeal req'd ---	date appr ---

WORK INFORMATION:

Size: Length 48' Width 34' Stories 1 Ground Floor Area 1410.33 sq'

Height _____ Building Volume (for demo. permit) _____ cu. ft.

Electrical: Installing new service, wiring, and devices.
brief description

Plumbing: Installing water and waste lines and fixtures.
brief description

Mechanical: Installing baseboard electric heat.
brief description

Sign: _____ Dimensions _____ Sign Area _____

Additional Information: SEE ATTACHED ADDENDUM:

Date 12-14-77 Applicant Signature *Charles Nizzi*
owner-agent

INSPECTION RECORD

	UNDERGROUND			ROUGH-IN						FINAL		
	Type	Date	By	Type	Date	By	Type	Date	By	Type	Date	By
PLUMBING	Building Drains			Drainage, Waste & Vent Piping	4/6/78	NSJ	Indirect Waste			Drainage, Waste & Vent Piping		
	Water Piping									Backflow Prevention		
	Building Sewer			Water Piping	4/6/78	NSJ	Condensate Lines			Water Heater		
	Sewer Connection										FINAL APPROVAL	
MECHANICAL	Refrigerant Piping			Refrigerant Piping			Chimney(s)			Grease Exhaust System		
				Duct Furnace(s)			Fire Dampers			Air Cond. Unit(s)		
	Ducts/ Plenums			Ducts/ Plenums			<input type="checkbox"/> Radiant Htr(s) <input type="checkbox"/> Unit Htr(s)			Refrigeration Equipment		
				Duct Insulation			Pool Heater			Furnace(s)		
				Combustion Products Vents			Ventilation <input type="checkbox"/> Supply <input type="checkbox"/> Exhst.			FINAL APPROVAL		
ELECTRICAL	Conduits & or Cable			Conduits/ Cable			<input type="checkbox"/> Range <input type="checkbox"/> Dryer			Temp Service Temp Lighting		
	Grounding & or Bonding			Rough Wiring	3/16/78	NSJ	<input type="checkbox"/> Generator(s) <input type="checkbox"/> Motors			Fixtures Lampholders		
	Floor Ducts Raceways			Service Panel Switchboard	3/11/78	NSJ	<input type="checkbox"/> Water Htr <input type="checkbox"/> Welder			Signs		
	Service Conduit			Busways Ducts			<input type="checkbox"/> Heaters <input type="checkbox"/> Heat Cable			Electric Mtr. Clearance		
	Temporary Power Pole			Subpanels			<input type="checkbox"/> Duct Htr(s) <input type="checkbox"/> Furnace(s)			FINAL APPROVAL	11-16-78 NSJ	
BUILDING	Location, Set-backs, Esmt(s)	12/19/77	NSJ	Exterior Wall Construction			Roof Covering Roof Drainage			Smoke Detector		
	Excavation						Exterior Lath			Demolition (sewer cap)		
	Footings & Reinforcing						<input type="checkbox"/> Interior Lath <input type="checkbox"/> Wallboard					
	Floor Slab			Interior Wall Construction			Fire Wall(s)			Building or Structure		
	Foundation Walls			Columns & Supports			Fireplace Chimney					
	Sub-soil Drain			Crawl Space <input type="checkbox"/> Vent <input type="checkbox"/> Access			Attic <input type="checkbox"/> Vent <input type="checkbox"/> Access					
	Piles			Floor System(s)						FINAL APPROVAL BLDG. DEPT.		
			Roof System			Special Insp Reports Rec'd			Certificate of Occupancy Issued			
ADDITIONAL	INSPECTIONS, CORRECTIONS, ETC.						INSPECTIONS, CORRECTIONS, ETC.					
	① outlet Bores (20. IN.)											
	ART- 370-6											
	Violations corrected 3/22/78 NSJ											
CHECKED 12/29/78 CABLE SIZE FROM METER TO PANEL NSJ												
AS PER COMPLAINT FROM COLMARAN ELECTRIC OK NSJ												

RESIDENTIAL PLAN CORRECTION SHEET

CITY OF NAPOLEON, Building Dept.
 255 West Riverview Avenue
 Napoleon, Ohio 43545
 (419) 592-4010

ADDENDUM to Permit No. 870-77
Owner Funchion&Nizzi
Location 90 Duquesne Dr.

Please note the Items checked below and incorporate them into your plans as indicated: Permit not yet issued
 Correct Plans and Re-Submit. Permit Issued Incorporate the Items during construction.

GENERAL	
<input checked="" type="checkbox"/> Provide 1 approved smoke detector.	Show size of members supporting porch roof.
<input type="checkbox"/> Provide 1 hour fire wall and/or ceiling between garage and dwelling.	Provide double top plate.
<input type="checkbox"/> Provide (Class B) 1 hour fire rated door from garage to dwelling.	Provide design data for pre-fab. wood truss/members.
<input type="checkbox"/> Submit fully dimensioned plot plan.	Ceiling joists undersized in.....
<input checked="" type="checkbox"/> Provide 1-3'0" x 6'8" exit door.	Roof rafters undersized in.....
<input checked="" type="checkbox"/> Provide min. 22" x 30" attic access.	
<input checked="" type="checkbox"/> Provide min. 18" x 24" crawl space access opening.	PLUMBING AND MECHANICAL:
LIGHT AND VENTILATION:	Terminate all exhaust systems to outside air.
Provide mechanical exhaust or window in bathroom.....	Insulate ducts in unheated areas.
Provide Min. _____ sq. in. net free area attic ventilation.	Provide back flow device on all hose bibs.
Provide min. _____ sq. in. net free area crawl space ventilation.	ELECTRICAL:
FOUNDATION:	Show location of service entrance and service equipment panel.
Min. depth of foundation below finished grade 30".	G.F.C.I. req'd. on Temp. Electric.
Min. size of footer....." x"	Outdoor and bathroom receptacles shall be protected by G.F.C.I.
Provide anchor bolts 1/2" @ 8' o.c. 1' from each corner. Embedded 8" concrete and 15" in masonry.	METAL VENEERS:
Show size of basement columns.	Contact City Utilities Dept. to remove conductors and/or meter.
FRAMING:	Provide 18" x 18" x 3/4" wood backer for meter base.
Show size of wood girder in.....	Provide approved system of grounding and bonding.
Provide design data for structural member in.....	MISCELLANEOUS:
Floor joists under sized in.....	Provide backwater valve in sub-soil drain tile.
Provide double joists under parallel partitions.	Provide approved sheathing and flashing behind masonry veneer.
Provide 1" x 4" let in corner bracing or approved sheathing.	Provide 15# felt underlayment on roof.
Show size of headers for openings over 4' wide.	Provide adequate fireplace hearth extensions
	Install factory built fireplaces/stoves according to manufacturers recommendations.
	Terminate chimney 3' above roof or 2' above highest point of building within 10' of chimney.

ADDITIONAL CORRECTIONS: 1 Hr GARAGE DOOR to add.

The approval of plans and specifications does not permit the violation of any section of the Building Code, or other City Ordinance or State Law. This addendum is attached to Permit No. 870-77 and made a part thereof.

Date Approved or Disapproved _____
 Date Rechecked and Approved _____

Checked By *[Signature]*
 Checked By _____
Plan Examiner

CITY OF NAPOLEON
BUILDING INSPECTION DEPARTMENT
APPLICATION FOR CONSTRUCTION PERMIT
(PLEASE PRINT OR TYPE)

PER. # 870-77
90 DUQUESNE

The undersigned hereby makes application for the construction, installation, replacement or alteration as herein specified, agreeing to do all such work in strict accordance with the City of Napoleon's Building Code for 1, 2 and 3 Family Buildings.

Owner's Name TERRY FUNCHION & CHARLES NIZZI Address 632 GROVER

Builder's Name RESIDENTIAL TECHNOLOGY Address 632 GROVER Tel. 782-0994

LOT INFORMATION: (Not required for roofing or siding job.)

Location of Project LOT # 60 RIVERA Hts Lot # 60

Subdivision RIVERA Hts Lot Area 9960 Sq. Ft.

Yard Setback: Front 30ft Rear 56' Left Side 16'

Right Side 16' Zoning District A

BUILDING INFORMATION:

Single Double _____ Multiple _____ New Construction

Attition _____ Remodel _____ Attached Garage YES

Detached Garage _____ Accessory Building _____ Replacement _____

Brief Description of Work: TWO STORY SINGLE FAMILY RESIDENCE WITH ATTACHED TWO CAR GARAGE OVER CRAWLSPACE.

Size: Length 34' Width 48' No. of Stories 2

Floor Area: 1st Floor 990 Sq. Ft. 2nd Floor 728 Sq. Ft.

3rd Floor _____ Sq. Ft. Basement _____ Sq. Ft.

Unfinished Attic _____ Garage 2-CAR FINISHED.

Foundation: ~~Block~~ AWWF (SEE ATTACHED BOOKLET) Part Basement _____

Concrete _____ Thickness _____ Block _____ Size _____

Walls: Frame Block _____ Brick _____ Other _____

Specific Type of Exterior Siding ALUMINUM DOUBLE 4

APPLICATION FOR PERMIT SHALL BE ACCOMPANIED BY TWO COMPLETE SETS OF PLANS INCLUDING: ELEVATIONS, FLOOR PLANS, CROSS SECTIONS AND PLOT PLAN. IF ADDITIONS OR REMODELING, SHOW ALL EXISTING STRUCTURE AND THEIR SIZE AND LOCATION. ALL PLANS SHALL BE DRAWN TO SCALE.

ESTIMATED COST OF COMPLETED PROJECT: \$52,000⁰⁰

DATE Dec 9, 1977 APPLICANT'S SIGNATURE Charles Nizzi Terry Funchion
OWNER-BUILDER-AGENT

CITY OF NAPOLEON
 BUILDING INSPECTION DEPARTMENT
 APPLICATION FOR ELECTRICAL PERMIT
 (PLEASE PRINT OR TYPE)

The undersigned hereby makes application for the installation, replacement, or alteration of electrical equipment as herein specified, agreeing to do all such work in strict accordance with the City of Napoleon's adopted Electrical Code for 1, 2 and 3 Family Buildings.

Owner's Name _____ Address _____ Tel. _____

Contractor's Name _____ Address _____ Tel. _____

LOT INFORMATION:

Location of Project LOT 60 Riviera Heights Zoning District A

BUILDING INFORMATION:

Single Family Double Family _____ Multiple Family _____

New Construction Existing _____ Addition _____

Replacement _____ Remodel _____ Service Charge Temporary to permanent

Size: Total Square Foot Per Floor 15,990 and 728 No. of Stories 2

DESCRIPTION OF WORK

Size of Service 200 AMP. Service Charge Only TEMP TO YES PERMANENT (Yes or No)

Total Number of New Circuits 24 Total Number of New Circuits Excluding Appliance Circuits 10

APPLIANCE CIRCUITS: (indicate quantity)

Electric Range 1 double pole Range Hood (1) Clothes Dryer 1 double pole Dishwasher (1)

Air Conditioner 2 double pole Attic Fan Blower (1) Room Exhaust Fan (1)

Disposal (1) Hot Water Heater 1 double pole Electric Oven _____

Require Temporary Electric yes (Yes or No)

Note: G.F.I.C. required for all temporary electric with approved ground rod at service

APPLICATION FOR PERMIT SHALL BE ACCOMPANIED BY TWO COMPLETE SETS OF PLANS INCLUDING: ELECTRICAL LAY-OUT AND RISER DIAGRAM.

ESTIMATED COST OF COMPLETED PROJECT: \$52,000.00

DATE 12-9-1977

APPLICANT'S SIGNATURE Charles Nizzi Jerry Trudgian
 OWNER-CONTRACTOR-AGENT

24	1.00
<u>23</u>	9.00
14	6.75
<u>9</u>	3.00
5	<u>19.75</u>

CITY OF NAPOLEON
 BUILDING INSPECTION DEPARTMENT
 APPLICATION FOR PLUMBING PERMIT
 (PLEASE PRINT OR TYPE)

The undersigned hereby makes application for the installation, replacement or alteration of plumbing system or device as herein specified, agreeing to do all such work in strict accordance with the City of Napoleon's adopted Plumbing Code for 1, 2 and 3 Family Buildings.

Owner's Name Terry Funchion + Charles Nizzi Address 632 GLOVER DETROIT, OHIO
 Contractor's Name RESIDENTIAL TECHNOLOGY Address 632 GLOVER Tel. 782-0994

BUILDING INFORMATION:

Single Family Double Family Multiple Family New Construction
 Addition Remodel Replacement No. of Stories 2

DESCRIPTION OF WORK

Drainage Pipe of: Cast Iron Copper Other PLASTIC (STORM)
CLAY (SANITARY)

Size of Main Building Drain: 4" PLASTIC
CLAY OUTSIDE

Size of Main Vent Stack: 3" 4" Other

Require Water Tap: YES (Yes or No) Require Sewer Tap: YES (Yes or No)

Size and Type of Water Tap 3/4"

Size and Type of Sewer Tap _____ Type of Joints O-ring

No. of Water Closets 3 No. of Sump Pumps 1

No. of Bathtubs 1 No. of Lavatories 3

No. of Kitchen Sinks DOUBLE No. of Automatic Washers 0

No. of Disposals 1 No. of Hot Water Heaters 1

No. of Dishwashers 0 No. of Shower Receptors 2

No. of Floor Drains _____ Other (specify) _____

Storm Drainage Outlet to: Storm Sewer Other

APPLICATION FOR PERMIT SHALL BE ACCOMPANIED BY TWO COMPLETE SETS OF A DRAINAGE ISOMETRIC, WITH ALL PIPES AND TRAPS PROPERLY SIZED. MUST INDICATE TOTAL DRAINAGE FIXTURE UNIT VALUE (dfu).

ESTIMATED COST OF COMPLETED PROJECT: \$ 52,000.00

DATE 12-9-1977 APPLICANT'S SIGNATURE Charles Nizzi Terry Funchion
 OWNER-CONTRACTOR-AGENT

3.00
 10.00
 13.00

425.25
 130.25

CITY OF NAPOLEON
 BUILDING INSPECTION DEPARTMENT
 APPLICATION FOR HEATING PERMIT
 (PLEASE PRINT OR TYPE)

The undersigned hereby makes application for the installation, replacement or alteration of a heating system or device as herein specified, agreeing to do all such work in strict accordance with the City of Napoleon's adopted Mechanical Code for 1, 2 and 3 Family Buildings.

Owner's Name _____ Address _____

Contractor's Name _____ Address _____ Tel. _____

BUILDING INFORMATION:

Single Family Double Family _____ Multiple _____ New Construction

Addition _____ Remodel _____ Replacement _____ No. of Stories _____

DESCRIPTION OF WORK

Heating System - Warm Air _____ Hot Water _____ Steam _____ Electric

Unit Heaters _____ Unit Gas Heaters _____ Other _____

Type - Gravity _____ Forced _____ Radiant BASEBOARD

No. of Thermostatical Heating Zone ~~ONE~~ 10

Hot Water - One Pipe _____ Two Pipe _____ Series Loop _____

Electric Heat - No. of Circuits 4 Other _____

Total Heat Loss of Area to be Heated 63,000 Btu/hr Btu.

Rated Capacity of Furnace/Boiler _____ Btu.

No. of Furnaces _____ No. of Hot Air Runs _____

No. of Hot Water Radiators _____ Type of Fuel _____

Heating Units Located: Crawl Space Floor Level Suspended _____

Roof or Exposed to Outside Air B Attic _____ Other _____

APPLICATION FOR PERMIT SHALL BE ACCOMPANIED BY TWO COMPLETE SETS OF PLANS INCLUDING: LOCATION OF FURNACE OR UNIT HEATERS AND SIZE AND LOCATION OF FEEDER DUCTS AND RETURN AIR DUCTS. ALL PLANS SHALL BE DRAWN TO SCALE.

ESTIMATED COST OF COMPLETED PROJECT: \$ 52,000.00

DATE Dec 9, 1977 APPLICANT'S SIGNATURE Charles Nizzi Terry Truncheon
 OWNER-CONTRACTOR-AGENT

#10.00

City of NAPOLEON, OHIO

255 RIVERVIEW AVENUE — (419) 592-4010

December 20, 1977



Terry Funchion & Charles Nizzi
632 Grover
Defiance, OH 43512

Mayor
Robert G. Heft

Clerk-Treasurer
Rupert W. Schweinhagen

Members of Council
Vern Holers, President
James Jackson
William Young
Earl Richardson
Lawrence Haase
David Strobel

City Manager
Alan E. Tandy

Law Director
Keith Muehlfeld

Dear Terry & Charles:

An inspection of your construction site at 90 Duquesne Road was conducted on December 19th and 20th, and we find that the excavation and installation of crushed stone is not being accomplished in a neat and workman-like manner. We therefore suggest that you either cease construction until ground conditions improve, or provide a pump to drain the area prior to installing more crushed rock.

This letter is to confirm our conversation regarding the installation of drain tile within the interior perimeter of the foundation.

In order to have this office approve the foundation work, the following will be required:

- 1) Install a pump and remove all standing water from the excavation.
- 2) Install drain tile around interior perimeter of the building with a positive pitch to the sump pit.
- 3) Drain tile must be installed below the bottom plate and be provided with a bedding of gravel 6" below the pipe and to a depth of 6" above the pipe.
- 4) This department must inspect the drain tile trench prior to installation of bedding and tile.
- 5) A pump is to be installed to maintain the water level not less than 6" below the foundation plate.

The alternative to compliance with the above requirements will be to exercise your privilege to appear before the Board of Building Appeals. If you desire to make such appearance, you may file a written appeal in this office and pay the required \$10 fee. The hearing date will then be established.

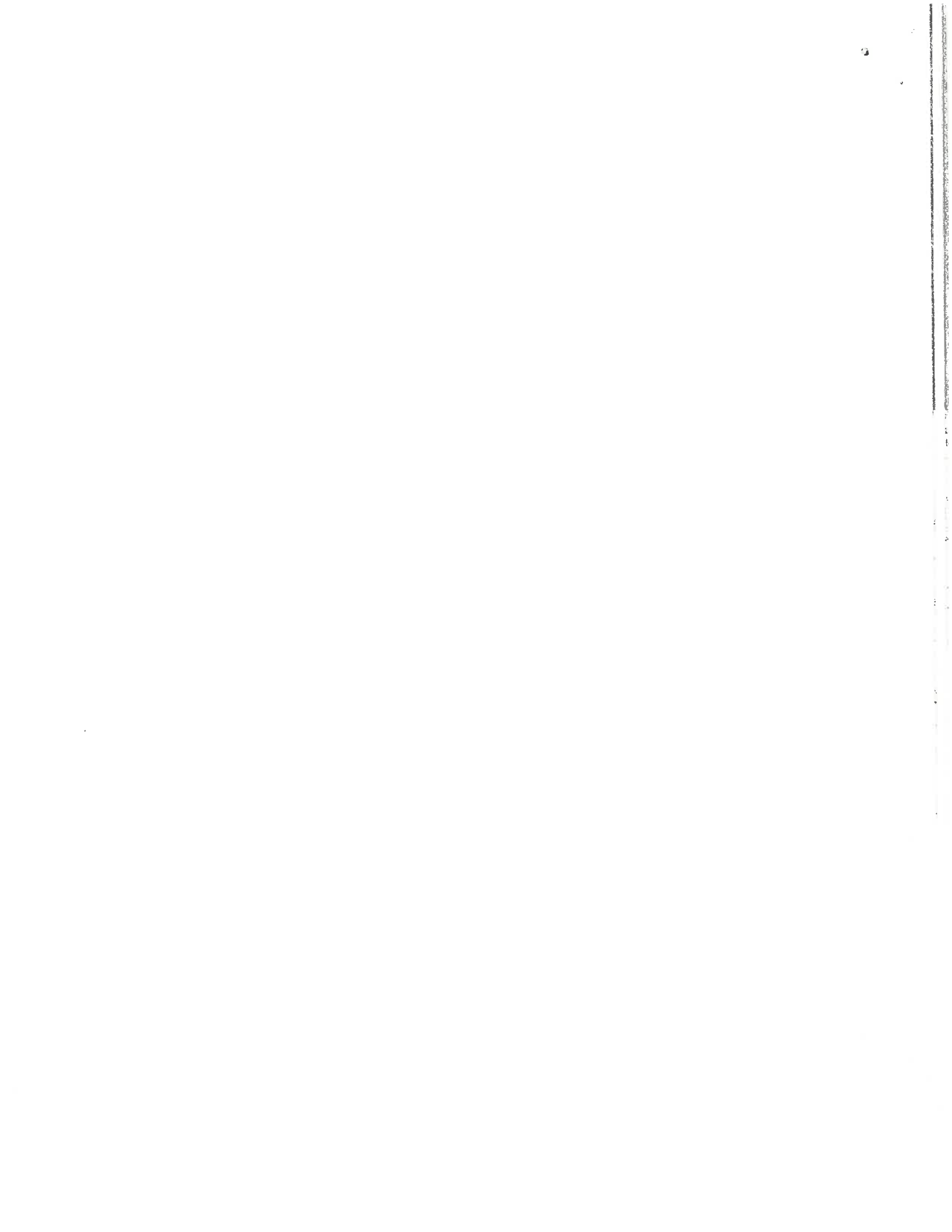

As stated on the job site on Monday, and again on Tuesday, "any foundation work installed after today will be done at your risk". Failure to install the foundation to the minimum requirements of this department or receipt of approval of the Building Board of Appeals will result in an order prohibiting work to proceed beyond the foundation stage.

Sincerely,

Robert E. Johnson
Dept. of Building & Zoning

REJ:dd



City of NAPOLEON, OHIO

255 RIVERVIEW AVENUE — (419) 592-4010

April 25, 1978

Mayor
Robert G. Heft

Mr. Terry Funchion
Mr. Charles Nizzi
632 Grover
Defiance, OH 43512

Clerk-Treasurer
Rupert W. Schweinhagen

Dear Sirs:

Members of Council
Vern Holers, President
Lawrence Haase
James Jackson
Marilyn Rausch
David Strobel
William Young

It has come to our attention that the foundation drainage, which is required around the perimeter of your building at 90 Duquesne, has not been installed.

City Manager
Alan E. Tandy

You are hereby reminded that this Department must inspect the excavation for the foundation drains, prior to installation of the drainage conduit. We also must inspect the trench following installation of the gravel base and conduit, prior to backfill.

Law Director
Keith Muehlfeld

Please call this office to arrange for the required inspections. With adequate notice, we will make the inspections at your convenience, during normal working hours of this Department.

Finally be advised that Section 85.49 of the Zoning Code requires that no building shall be occupied or used prior to the issuance of a "Certificate of Occupancy". The "Certificate of Occupancy" will be issued when all work has been completed under the inspection procedures of this Department.

Sincerely,

Robert E. Johnson
Dept. of Building & Zoning

REJ:dd

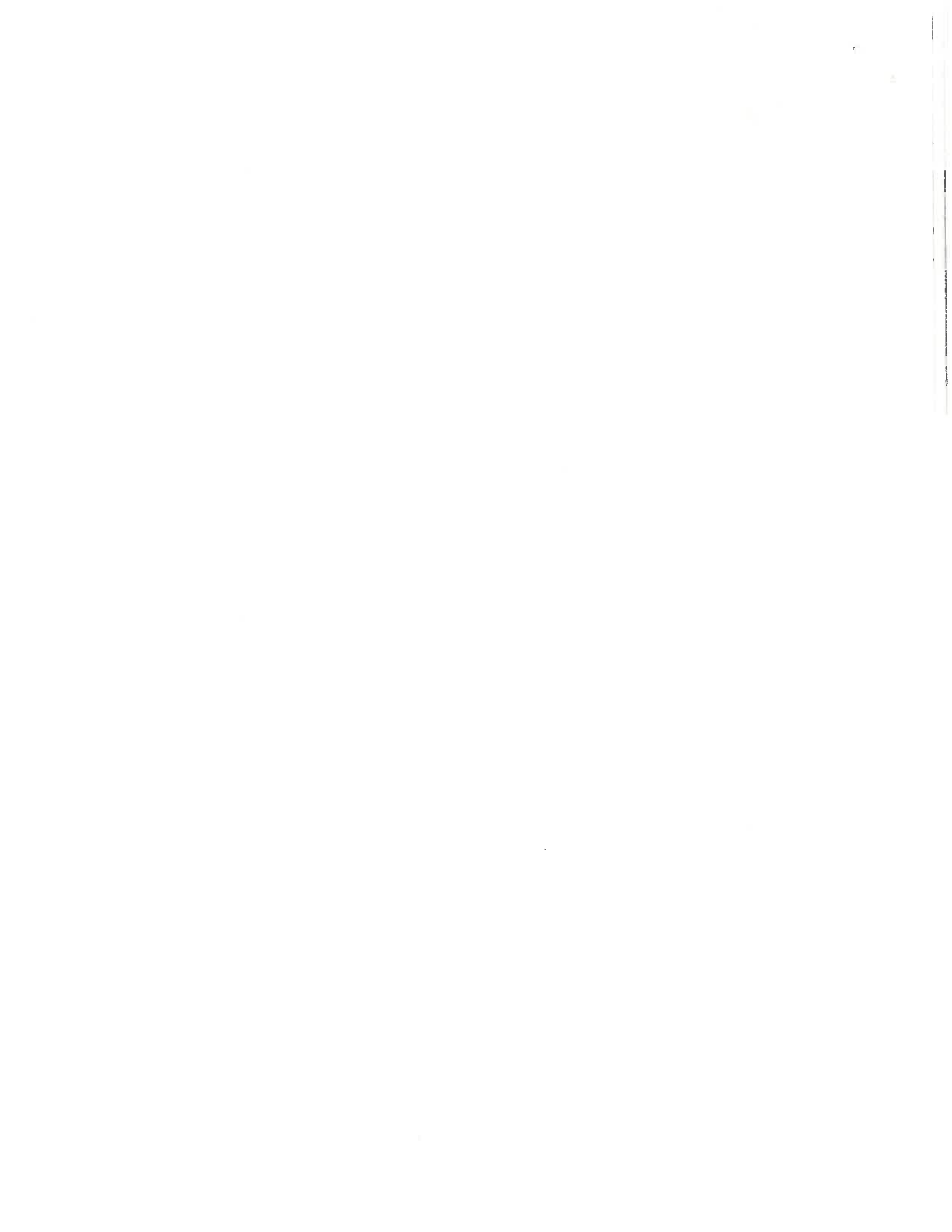

Date: 12-14-77

Electric Distribution Superintendent
The Building Inspector - Building Department

confirm the installation of 200 AMP. electrical
entrance, located NORTH EAST END OF HOUSE ON GARAGE

following address: 90 DUQUESNE

LOT #60

Not Approved

Runge
Electric Supt.

12-15-77
Date

Rome said OK.

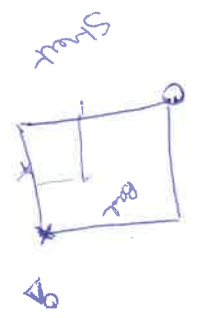

0

Distribution Superintendent
Engineering Inspector - Building Department

Date: 12-14-77

Proposed installation of 3/4" water tap
OF PROPOSED

Address: 90 ~~BRIDGE~~ DR. Lot # 60
DUQUESNE

Not Approved

Schmitky 12-20-77
Date

*6" service - 6" lays only on
of Lot, have contractor
as to location of tap*

172380
Robert Schesky



No.

182

CERTIFICATE OF OCCUPANCY
THE CITY OF NAPOLEON

ENGINEERING DEPARTMENT
DIVISION OF INSPECTION

This is to certify that the Building or Land as herein described complies with all the building and health laws and ordinances and with the provisions of the Zoning Ordinance.

Location of Occupancy 90 Duquesne Drive Occupancy Single Family Dwelling

Owner of Property Terry Funchion & Charles Nizzi Address 632 Grover, Defiance, Ohio

Issued to Terry Funchion & Charles Nizzi Address 632 Grover, Defiance, Ohio

Zoning "A" Residence District Bldg. Permit No. 870-17

Substantial qualifications of occupancy

This certificate is issued by the City Building Inspector, as provided by law, and is to certify that construction is completed substantially in conformity with the approved plans and permission is hereby granted to occupy such building in compliance with such legal use and occupancy as authorized under the provisions of the ordinances of the City of Napoleon.

Issued this 26th day of March 19 79

This is a valuable record for owner or lessee and should be so preserved. Signed [Signature] City Building Inspector

